



MATHIAS BÄUERLE

Mathias Bäuerle GmbH · Gewerbehallestraße 7-11

D-78112 St.Georgen · Telefon (07724) 882-0 · Telefax (07724) 882-111

Internet: <http://www.mbfold.de> · E-mail: center@mbfold.de

Interface IF 42

Operator's Manual

CONTENTS

1. General Description	5
2. Specifications	6
3. Proper Handling of the Machine	7
4. Safety Instructions	9
5. Description	13
6. Adjustments	14
Height Adjustment	14
Height Compensation	14
Transport Belts, Ball Rails	14
Selection of Balls	14
Paper Guide Brackets	15
Hold-Down Rollers	15
Transport Speed	15

The title, copyright and all other proprietary rights in this document are vested in Mathias Bäuerle GmbH and no part of it may be reproduced in any form without the written permission of Mathias Bäuerle GmbH.

1. GENERAL DESCRIPTION

The interface bridge IF42 has been designed for sheet transport between paper handling systems with different infeed and outfeed heights. It receives and transports single, cut sheets of paper. The angle and basic height of the bridge can be easily adapted to various requirements.

Typical applications are, for example, handling continuous forms in lettershop systems or the height compensation between a printing system and subsequent components.

When the IF42 is used with the MB fold system CAS 52/4, power is supplied via the receptacle in the fold unit.

The interface IF42 consists of the following components:

- 1 Height adjustable cabinet
- 2 Handwheel
- 3 Transfer bridge
- 4 Potentiometer for speed adjustment
- 5 On/Off switch

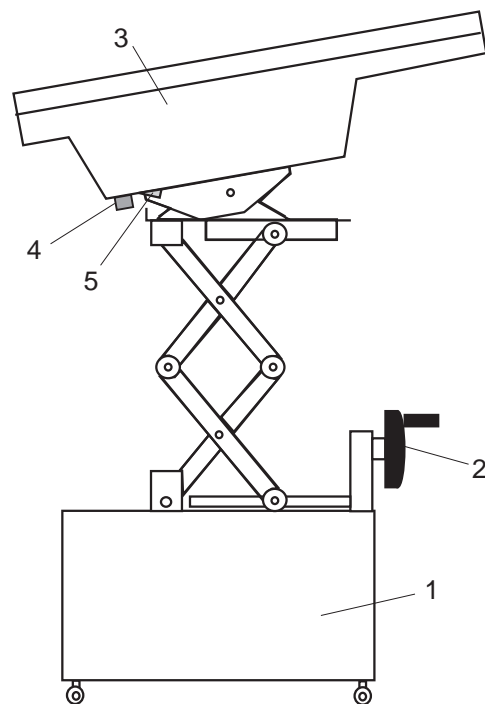

2. SPECIFICATIONS

Performance:

- Speed: from 18 m/min to 180 m/min

Paper sizes:

max. width 420 mm min. width 210 mm
max. length 420 mm min. length 210 mm
(smaller paper sizes depend on the application)

Paper weight:

60 - 200 GSM

Electrical:

Voltage: 230 V (115V upon request)
Frequency: 50 Hz (60 Hz upon request)
Power consumption: 300 W
Fuse: T8A

Dimensions:

Length: 800 mm
Width: 560 mm

Transfer heights:

min.: 800 mm
max. 1200 mm
max. height difference: 230 mm

Colour:

RAL 7035 (light grey)

3. PROPER HANDLING OF THE MACHINE

The height-adjustable interface bridge IF42 is built for transporting single sheets of paper.

It is unsuitable for handling other materials, such as foils, plastics or textiles.

The manufacturer/distributor is not responsible for damages resulting from such unsuitable applications. Responsibility lies alone with the user.

Installation of the machine, i.e. assembling as well as electrical work should be carried out only by skilled personnel authorized by the manufacturer or his representatives. Additional instructions are provided for this purpose.

Repairs and service should be carried out only by skilled personnel authorized by the manufacturer or his representatives.

The interval between inspections including safety-related functions depends on the machine usage. For regular one-shift-operation, one inspection per year is recommended.

The machine weight should be considered when choosing a location for the machine.

No harmful emissions are produced.

Read the operator's manual before working with the machine!

We recommend to carry out all operations and settings in the sequence mentioned in this manual.

4. SAFETY INSTRUCTIONS

4.1 Safety Instructions for Transport and Set-Up

The following instructions and warnings are applied to the packing to ensure appropriate and safe transport.

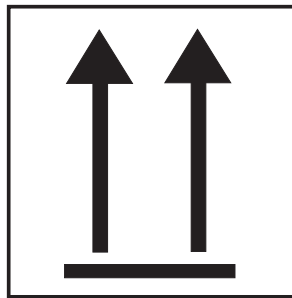

Top! Transport in upright position only!



Protect from humidity!



Fragile! Handle with care!

These instructions and warnings must also be observed for transport within the users premises.

For transport to other premises resp. for return shipment the machine must be packed and provided with the same markings.

4.2 Fundamental Safety Instructions

Warnings and Symbols

The following symbols and designations are used in the manual to identify instructions of particular importance:



General instructions and special information how to use the machine most efficiently.



Instructions designed to prevent injury or extensive equipment damage.

Basic Operation

The machine has been built in accordance with state-of-the-art standards and the recognized safety rules.

Nevertheless, operators and third parties may get injured when working with the machine, or damage to the machine and to other material property may result.

The machine must only be used in technically perfect condition in accordance with its designated use and the instructions set out in the operator's manual.

Any malfunctions, especially those affecting the safety of the machine, should therefore be rectified immediately.

Organizational Measures

The operator's manual must always be available near the machine.
In addition to reading the operator's manual, observe and instruct the user in all other prevention and environmental protection.
The operator's manual must be supplemented by instructions covering the duties involved in supervising and notifying special organizational features such as job organization, working sequences or the personnel entrusted with the work.
Personnel entrusted with work on the machine must have read the operator's manual and in particular the chapter on safety before beginning the work.
Reading the instructions after work has begun is too late.
This applies especially to persons working occasionally on the machine, e.g. during setting up or maintenance.
Check, at least from time to time, whether the personnel is carrying out the work in compliance with the operator's manual and paying attention to risks and safety factors.
For reasons of safety, long hair must be tied back or otherwise secured, garments must be close-fitting and no jewellery - such as rings - may be worn.
Injury may result from being caught on moving parts.
Observe all safety instructions and warnings attached to the machine.
See to it that safety instructions and warnings attached to the machine are always complete and perfectly legible.
In the event of safety-relevant modifications or changes in the performance of the machine during operation, stop the machine immediately and report the malfunction to the competent person.
Never make any modifications, additions or conversions which might affect safety without the manufacturer's approval. Adhere to prescribed intervals or those specified in the operator's manual for routine checks and inspections.

Selection of Personnel, Basic Responsibilities

Employ only trained or instructed staff and set out clearly the individual responsibilities of the personnel for operation, set-up, maintenance and repair.
Work on the electrical system and equipment of the machine must be carried out only by a skilled electrician in accordance with electrical engineering rules and regulations.

Standard Operation

Avoid any operational mode that might be detrimental to safety.
Take the necessary precautions to ensure that the machine is used only in a safe and reliable state. Operate the machine only if all protective and safety-oriented devices, such as removal safety devices, emergency stops, sound proofing elements, are in place and fully functional.
In the event of malfunctions stop the machine immediately and prevent further use.
Have any defects rectified immediately.
Before starting up or setting the machine in motion, make sure that nobody is in danger.

Special Work, Maintenance, Repair

Observe the adjusting, maintenance and inspection activities and intervals set out in the operator's manual, including information on the replacement of parts and equipment.
If the machine is completely shut down for maintenance and repair work, it must be secured against inadvertent starting by attaching a warning sign to the main switch.
Always tighten any screw connections that have been loosened during maintenance and repair.

Special Dangers

The electric equipment of machines is to be inspected and checked at regular intervals.

Defects such as loose connections or scorched cables must be rectified immediately.

Product-Specific Safety Instructions



Exercise caution in the vicinity of rotating shafts and rollers!

Hair, loose garments and jewellery may get caught!

SERIOUS INJURY MAY RESULT!

4.3 Cleaning and Maintenance

Regular and proper cleaning contributes to a long life of the machine and a consistent quality. Therefore it is important to clean the machine in regular intervals and above all to remove paper dust.

The interval between maintenance jobs depends on the workload.

It is recommended to clean the machine once a week.



Before cleaning the machine always pull the power plug!

5. DESCRIPTION

System Layout

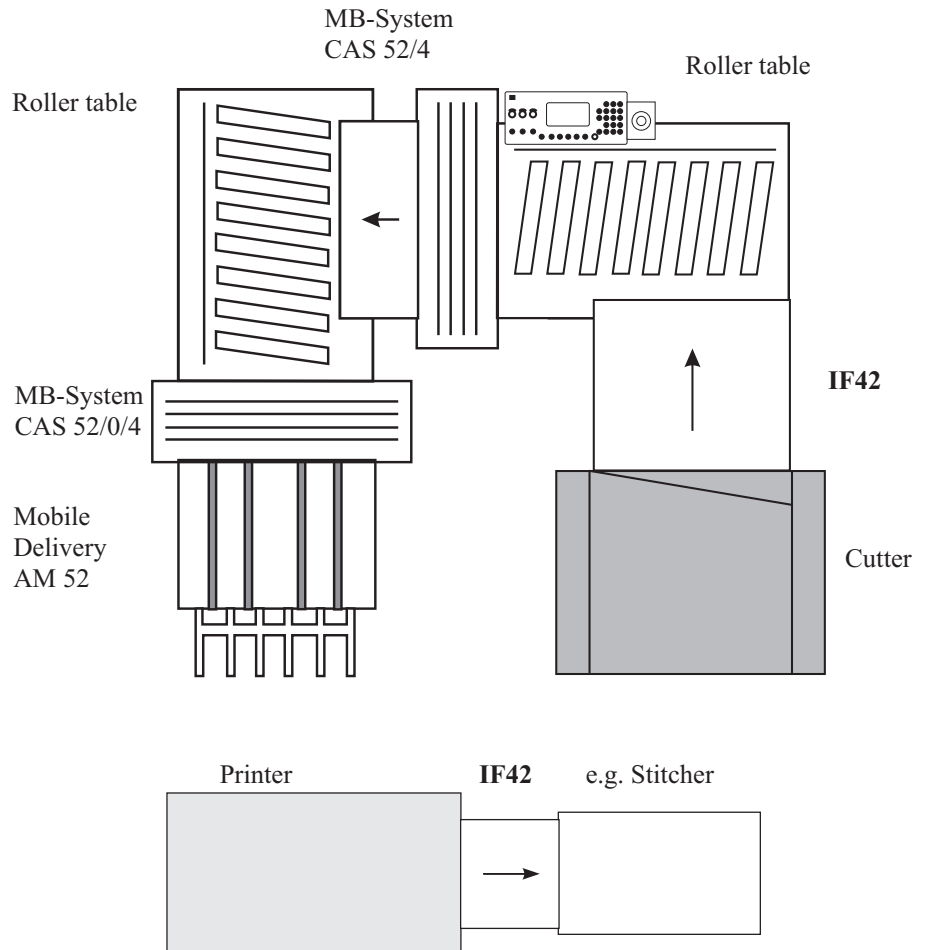

Side View

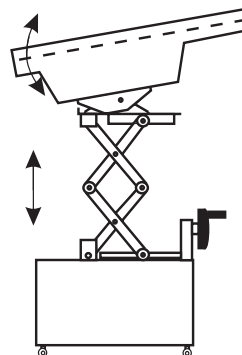

6. ADJUSTMENTS

Height Adjustment

The height is adjusted by turning the handwheel (1) on the cabinet.

- Turning the handwheel clockwise will raise the transfer bridge.
- Turning the handwheel counter-clockwise will lower the transfer bridge.

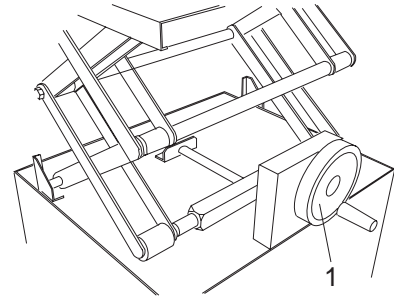

Height Compensation

The angle of the transfer bridge can be adjusted as follows:

- Loosen the Allen screws (2) on both sides.
- Adjust the angle of the bridge.
- Retighten the Allen screws (2).

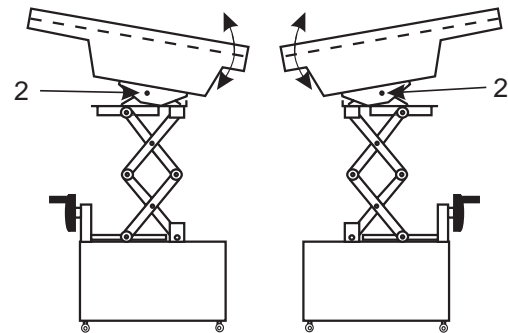

Transport Belts, Ball Rails

Two flat belts and ball cages guide the sheets.

The flat belts (3) should be adjusted in such a way that the sheets are guided properly at the inside of the edges.

To adjust the flat belts, loosen the Allen screws of the flat belt rollers (4). Move belts and rollers to the desired position. Retighten the Allen screws (4).

The balls in the ball cages (5) must always run on the flat belts.

After repositioning the flat belts, also adjust the ball rails.

For this, loosen the knurled screws (6).

Shift the ball rails to the new position. Retighten the knurled screws (6).

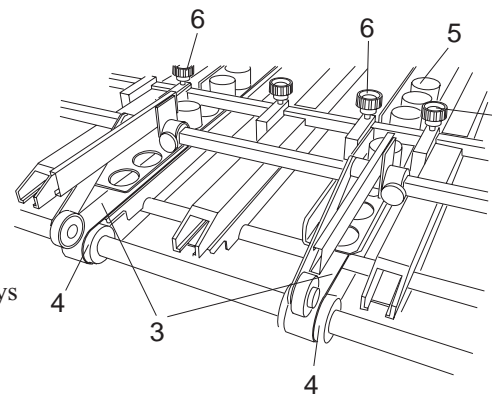

Selection of Balls

The ball cages (5) can be equipped with plastic- or steel balls.

This is determined by paper quality and paper weight.

light or soft paper:	plastic balls
heavy or hard paper:	steel balls

To change the balls, first remove the ball cages from the guide rail by turning them counter-clockwise. Push the ball out of the ball cage by means of a pin.

Introduce a new ball. Re-insert the ball cage in the guide rail.



Introduce the ball cages in such a manner that the arrows always point in direction of paper travel.

Paper Guide Brackets

The upper paper guide brackets can be adjusted, if necessary. For this, loosen the knurled screws (2) and reposition the brackets. Retighten the knurled screws.

Shift the lower guide brackets to the requested position.

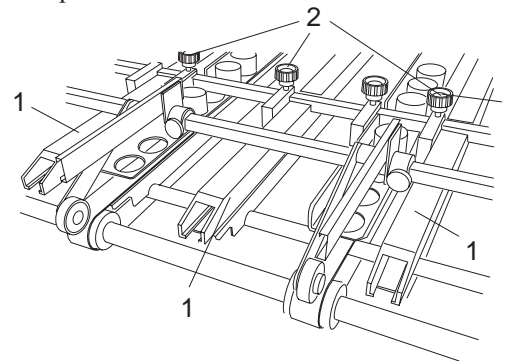

Hold-Down Rollers

Adjust the hold-down rollers in the delivery section of the transfer bridge in such a way that the sheets are transported securely to the subsequent machine.

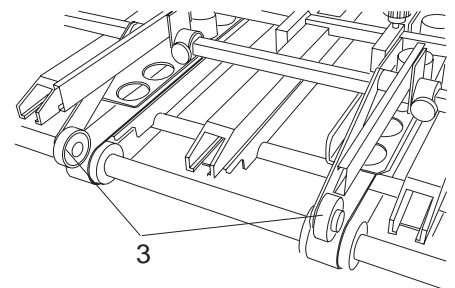

Transport Speed

The transport speed can be adjusted by means of a potentiometer (4) at the bottom of the transfer bridge.

